



FACILITY SPECIFICATIONS

CAREER & TECHNICAL EDUCATION

AGRICULTURE EDUCATION

*Specifications for
New and Remodeled
Classrooms/Labs*



**CAREER
CONNECTION**
Volusia/Flagler Consortium

www.career-connection.org



FACILITY SPECIFICATIONS CAREER & TECHNICAL EDUCATION

Agriculture Education

Table of Contents

Program Organization	1
Volusia Variance Justification	2
Infrastructure	3 -4
Furniture and Equipment	5 - 6
Hardware and Software	7
Floor Plan	8 - 9

Facility Specifications/High School/Agriculture Education

PROGRAM ORGANIZATION

General Standards

Program Specifics	Number
Teacher Student Ratio	1:30
Student Capacity per Period/Block	30
Teachers	1
Aides	0
Grade Levels for Program	9-12
Hours per Day Space Occupied	7.5

State Facility Standards

Facility	Lab Facility <i>(square footage standards)</i>
Dirty Lab	2560
Material Storage	395
Classroom/Lab	780
Reference	100
Flammable Storage	125
Machinery Storage	1100
Tool Storage	195
Lockers(2)	450
Total	5,705

Volusia Variance of Standards

Facility	Lab Facility <i>(square footage standards)</i>
Dirty Lab	1520
Material Storage (A and B)	800
Classroom/Lab	3385
Reference	0
Flammable Storage	0
Machinery Storage	0
Tool Storage	0
Lockers(2)	0
Teacher Planning	115
Total	5,820

Facility Specifications/High School/Agriculture Education

VOLUSIA VARIANCE JUSTIFICATION

Facility	State Lab Facility <i>(square footage standards)</i>	Volusia Lab Facility <i>(square footage standards)</i>	Volusia Variance Justification
Dirty Lab	2560	1520	Reduced to add square footage to classroom
Material Storage	395	800	Combined material with lockers.
Classroom/Lab	780	3385	Combined classroom, tool, machinery, flammable, reference, and part of dirty to accommodate tables and 30 computers.
Reference	100	0	N/A
Flammable Storage	125	0	N/A
Machinery Storage	1100	0	N/A
Tool Storage	195	0	N/A
Lockers(2)	450	0	N/A
Teacher Planning	0	115	State standard does not allow for Co-op/OJT coordination
TOTAL	5,705	5,820	

Facility Specifications/High School/Agriculture Education

INFRASTRUCTURE

Items	Considerations
Heating/Cooling/Ventilation	<ul style="list-style-type: none"> ▪ Proper cooling for classroom/computer Lab ▪ Proper ventilation for traditional dirty lab
Acoustical	<ul style="list-style-type: none"> ▪ Sound buffering/deafening in dirty lab and classroom/lab
Floors	<ul style="list-style-type: none"> ▪ Non-slip in dirty lab ▪ Center drain in dirty lab
Walls	<ul style="list-style-type: none"> ▪ One (1) white board/tack board combination ▪ Two (2) tack/bulletin boards
Ceiling	<ul style="list-style-type: none"> ▪ Mounted projector and retractable screen in Classroom/Lab
Lighting	<ul style="list-style-type: none"> ▪ General lighting for all HS Agriculture interior labs ▪ Non-glare lighting appropriate for computer viewing in classroom/computer lab ▪ Task lighting for dirty lab
Windows	<ul style="list-style-type: none"> ▪ Exterior vertical room-darkening blinds for presentations ▪ Interior viewing windows between: <ol style="list-style-type: none"> 1. teacher planning and classroom/computer lab 2. teacher planning and dirty lab 3. classroom/computer lab and dirty lab
Doors	<ul style="list-style-type: none"> ▪ Dirty lab must have double door to <u>exterior</u> land lab ▪ Double door between classroom/lab and dirty lab
Water	<ul style="list-style-type: none"> ▪ Deep utility sinks with hot/cold water in dirty lab ▪ Irrigation and hose bibs for <u>exterior</u> land lab ▪ Hose bibs on exterior walls of traditional dirty lab ▪ Water fountain
Communications	<ul style="list-style-type: none"> ▪ Telephone in teacher planning ▪ Computer data/internet ports for 32 computers in classroom/lab; 1 computer in teacher planning ▪ Call buttons in traditional dirty lab and classroom/computer lab

Facility Specifications/High School/Agriculture Education

INFRASTRUCTURE (continued)

Items	Considerations
Electrical	<ul style="list-style-type: none"> ▪ Outlets every five (5) feet in dirty lab for equipment (20 amp) ▪ Outlets in storage spaces. ▪ Outlets and data/internet ports in classroom/lab to support 32 computers; 1 computer in teacher planning ▪ Outlets in ceiling and on walls for dirty lab equipment ▪ Outside outlets on wall for exterior land lab
Gas and Air	<ul style="list-style-type: none"> ▪ Standard
Safety	<ul style="list-style-type: none"> ▪ Computer wire management ▪ Emergency shut offs in dirty lab, classroom/lab, and teacher planning
Fencing	<ul style="list-style-type: none"> ▪ Fencing around entire exterior land lab
Service Drive	<ul style="list-style-type: none"> ▪ HS Agriculture interior labs and exterior land lab need access to service drive for deliveries.
Parking	<ul style="list-style-type: none"> ▪ N/A
Built-Ins	<p>Classroom/Lab</p> <ul style="list-style-type: none"> ▪ <u>Wall Unit A</u>: upper locking cabinets; counter for computing; knee space; printer counter; full corner cabinet with locking doors ▪ <u>Wall Unit B</u>: upper locking cabinets on one side; no upper cabinets on other side – viewing window to dirty lab; counter for computing; knee space <p>Dirty Lab</p> <ul style="list-style-type: none"> ▪ <u>Wall Unit</u>: upper/lower locking cabinets; counter; refrigerator; deep industrial sink
Location	<ul style="list-style-type: none"> ▪ HS Agriculture interior labs MUST BE next to exterior land lab! ▪ Close to restroom facilities
Exterior Land Lab	<ul style="list-style-type: none"> ▪ HS land lab is ¼ acre in size or 150'x 75'. ▪ Shade house is approximately 50' x 75' and should have plant tables and overhead irrigation. ▪ Shade house is approximately 50'x75' and should have plant tables and overhead irrigation. ▪ The remainder of the land lab is for in-ground horticulture projects with in-ground irrigation ▪ Hose bibs are required every 50' on each side of the land lab. ▪ Chain link fence around entire land lab area

Facility Specifications/High School/Agriculture Education

FURNITURE AND EQUIPMENT

AREA	ROOM TYPE	ITEM	QUANTITY
Agriculture Education	Classroom/Lab	Board, White/Tack Combination, Teaching Wall	1
Agriculture Education	Classroom/Lab	Bookcase	1
Agriculture Education	Classroom/Lab	Built-In Computer Counters, Perimeter, Knee Hole	3
Agriculture Education	Classroom/Lab	Built-In Student Cubbies	1
Agriculture Education	Classroom/Lab	Case, Display w/ Locks	2
Agriculture Education	Classroom/Lab	Chairs, Student, Zuma, 18", One Piece	32
Agriculture Education	Classroom/Lab	Clock	1
Agriculture Education	Classroom/Lab	Flag w/ Holder	1
Agriculture Education	Classroom/Lab	Lectern, 2 Piece, Adjustable Shelf, Assembled, Rolling	1
Agriculture Education	Classroom/Lab	Media/Presentation Cart - Rolling w/ Locking Wheels and Storage	1
Agriculture Education	Classroom/Lab	Pencil Sharpener, Electric	1
Agriculture Education	Classroom/Lab	Pencil Sharpener, Manual, Wall Mount	1
Agriculture Education	Classroom/Lab	Stools, Adjustable, 24"-30"	32
Agriculture Education	Classroom/Lab	Table, Student, 60"x30"	16
Agriculture Education	Classroom/Lab	Tack Board	1
Agriculture Education	Classroom/Lab	VCR/DVD Combo	1
Agriculture Education	Classroom/Lab	Waste Basket, Plastic, 28 1/8	2
Agriculture Education	Dirty Lab	Aquariums, 10 Gallon	2
Agriculture Education	Dirty Lab	Brooms, Push	2
Agriculture Education	Dirty Lab	Built-In Cabinetry, Upper/Lower Locking; Counters; Industrial Sink	1
Agriculture Education	Dirty Lab	Cabinet, Sanitizing (for Goggles)	1
Agriculture Education	Dirty Lab	Cages, Small Animals	4
Agriculture Education	Dirty Lab	Clippers, Large Animal	1
Agriculture Education	Dirty Lab	Clippers, Nursery	15
Agriculture Education	Dirty Lab	Clippers, Small Animal	1
Agriculture Education	Dirty Lab	Clock	1
Agriculture Education	Dirty Lab	Drill Press	1
Agriculture Education	Dirty Lab	Dust Pans	2
Agriculture Education	Dirty Lab	Gargage Cans, Large, w/ Lids	2
Agriculture Education	Dirty Lab	Goggles, Safety	45
Agriculture Education	Dirty Lab	Grow Lab, Hydroponic	1
Agriculture Education	Dirty Lab	Grow Labs, Plant	1
Agriculture Education	Dirty Lab	Hammers	6
Agriculture Education	Dirty Lab	Hand Sprayer, Weed	1
Agriculture Education	Dirty Lab	Hood, Science, Exhaust (<i>vented to outside</i>)	1
Agriculture Education	Dirty Lab	Hood, Tissue Culture, Vertical Laminar Airflow	2
Agriculture Education	Dirty Lab	Hoses, Assorted	6
Agriculture Education	Dirty Lab	Hotplate	2
Agriculture Education	Dirty Lab	Incubator, Seedling	1
Agriculture Education	Dirty Lab	Miter Box	1
Agriculture Education	Dirty Lab	Mops	2
Agriculture Education	Dirty Lab	Pencil Sharpener, Electric	1
Agriculture Education	Dirty Lab	Pencil Sharpener, Manual, Wall Mount	1
Agriculture Education	Dirty Lab	Rakes, Assorted	3
Agriculture Education	Dirty Lab	Refridgerator, w/ Freezer	1
Agriculture Education	Dirty Lab	Roto Tiller	1
Agriculture Education	Dirty Lab	Router	1
Agriculture Education	Dirty Lab	Sander	2
Agriculture Education	Dirty Lab	Saw, Band	1
Agriculture Education	Dirty Lab	Saw, Circular	1

IMPORTANT: Items and Quantities may change as floor plan size is modified!

Facility Specifications/High School/Marketing Education

FURNITURE AND EQUIPMENT (continued)

AREA	ROOM TYPE	ITEM	QUANTITY
Agriculture Education	Dirty Lab	Saw, Hand	6
Agriculture Education	Dirty Lab	Saw, Jig	1
Agriculture Education	Dirty Lab	Saw, Skil	2
Agriculture Education	Dirty Lab	Screw Drivers, Assorted	5
Agriculture Education	Dirty Lab	Shovels	15
Agriculture Education	Dirty Lab	Shovels, Hand	10
Agriculture Education	Dirty Lab	Spreader	1
Agriculture Education	Dirty Lab	Stools, Adjustable, 24"-30"	36
Agriculture Education	Dirty Lab	Tables, Workbench, 5'X5'	6
Agriculture Education	Dirty Lab	Tanks Aquaculture, w/ Pump, 400 Gallons	1
Agriculture Education	Dirty Lab	Tattoo, Small Animal	1
Agriculture Education	Dirty Lab	Themometer, Animal	10
Agriculture Education	Dirty Lab	Tool Set, Hand	3
Agriculture Education	Dirty Lab	Trowels	15
Agriculture Education	Dirty Lab	Wheel Barrow	2
Agriculture Education	Storage A	Shelving, Perimeter, Open, Adjustable	1
Agriculture Education	Storage B	Shelving, Perimeter, Open, Adjustable	1
Agriculture Education	Teacher Planning	Built-In Bookcase, Open	1
Agriculture Education	Teacher Planning	Chair, Teachers w/ Rollers	1
Agriculture Education	Teacher Planning	Clock	1
Agriculture Education	Teacher Planning	Desk, Teachers	1
Agriculture Education	Teacher Planning	Filing Cabinets, Legal	2
Agriculture Education	Teacher Planning	Mat, Chair	1
Agriculture Education	Teacher Planning	Pencil Sharpener, Electric	1
Agriculture Education	Teacher Planning	Printer Color	1
Agriculture Education	Teacher Planning	Tack Board	1
Agriculture Education	Teacher Planning	Waste Basket, Plastic, 28 1/8	1

IMPORTANT: Items and Quantities may change as floor plan size is modified!

Facility Specifications/High School/Agriculture Education

COMPUTER HARDWARE AND SOFTWARE

AREA	ROOM TYPE	ITEM	QUANTITY
Agriculture Education	Classroom/Lab	Computers - Multi-Media, Student, Internet Ready/DVD-RW	30
Agriculture Education	Classroom/Lab	Computer - Multi-Media, Teacher Presentation, Internet Ready/DVD-RW	1
Agriculture Education	Classroom/Lab	Overhead Projection System - LCD/Elmo	1
Agriculture Education	Classroom/Lab	Printer - Network, B/W	1
Agriculture Education	Classroom/Lab	Projector - Ceiling Mount	1
Agriculture Education	Classroom/Lab	Screen - Ceiling Mount, Retractable	1
Agriculture Education	Teacher Planning	Computer - Multi-Media, Teacher, Internet Ready/DVD-RW	1
Agriculture Education	Teacher Planning	Printer, Stand Alone, Color Ink Jet	1
Agriculture Education	Teacher Planning	Telephone	1

IMPORTANT: Please contact Dan Cox, Agriculture Education Specialist, for *Agriculture* specific software at 386-255-6475 x60216.

Facility Specifications/High School/Agriculture Education

FLOOR PLAN

NO POWER POLES. All power, data ports, internet to come from the walls.

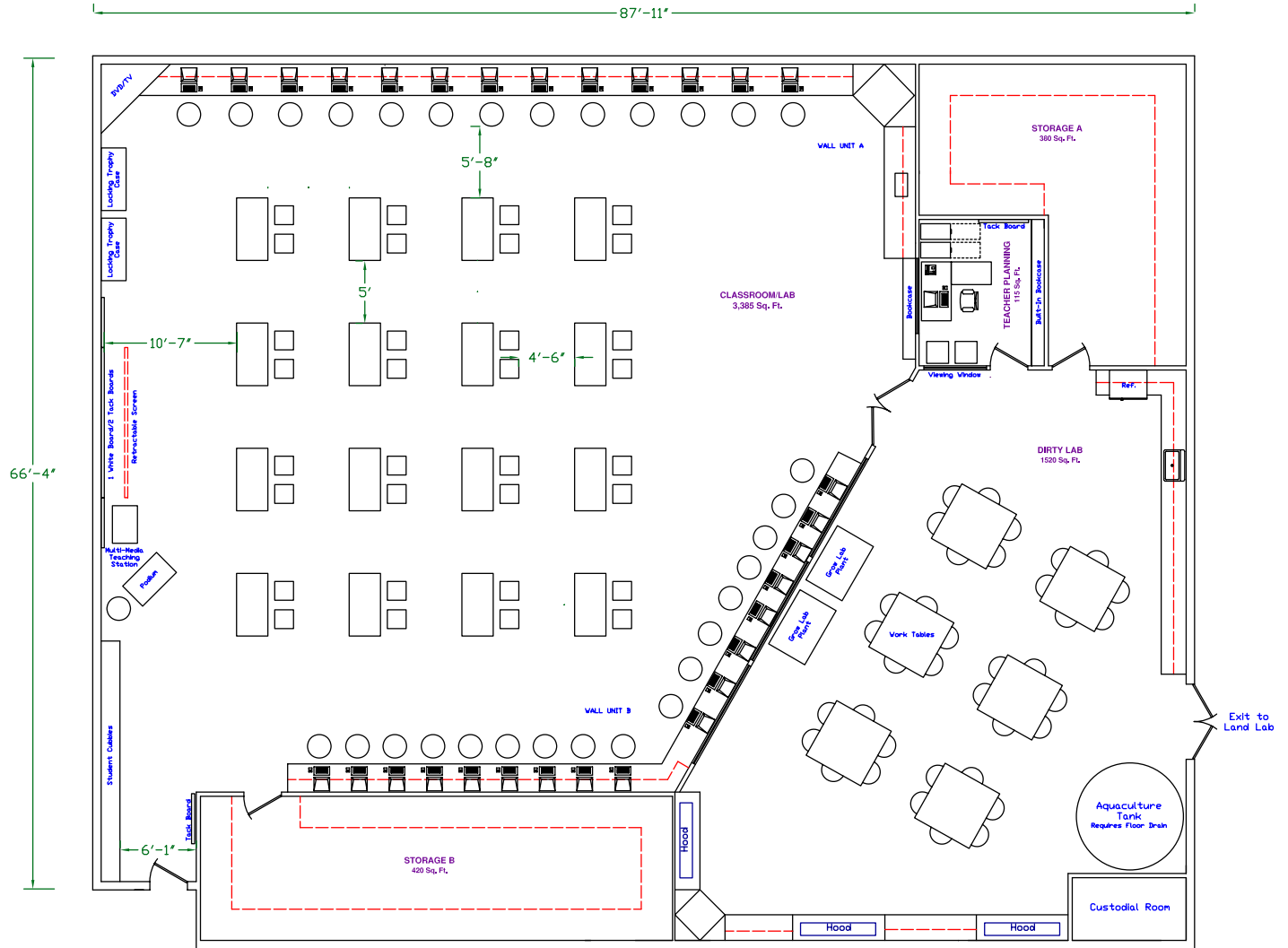

Please contact Kristin B. Pierce at x60180 for an AutoCAD drawing.

Facility Specifications/High School/Agriculture Education

FLOOR PLAN (continued)

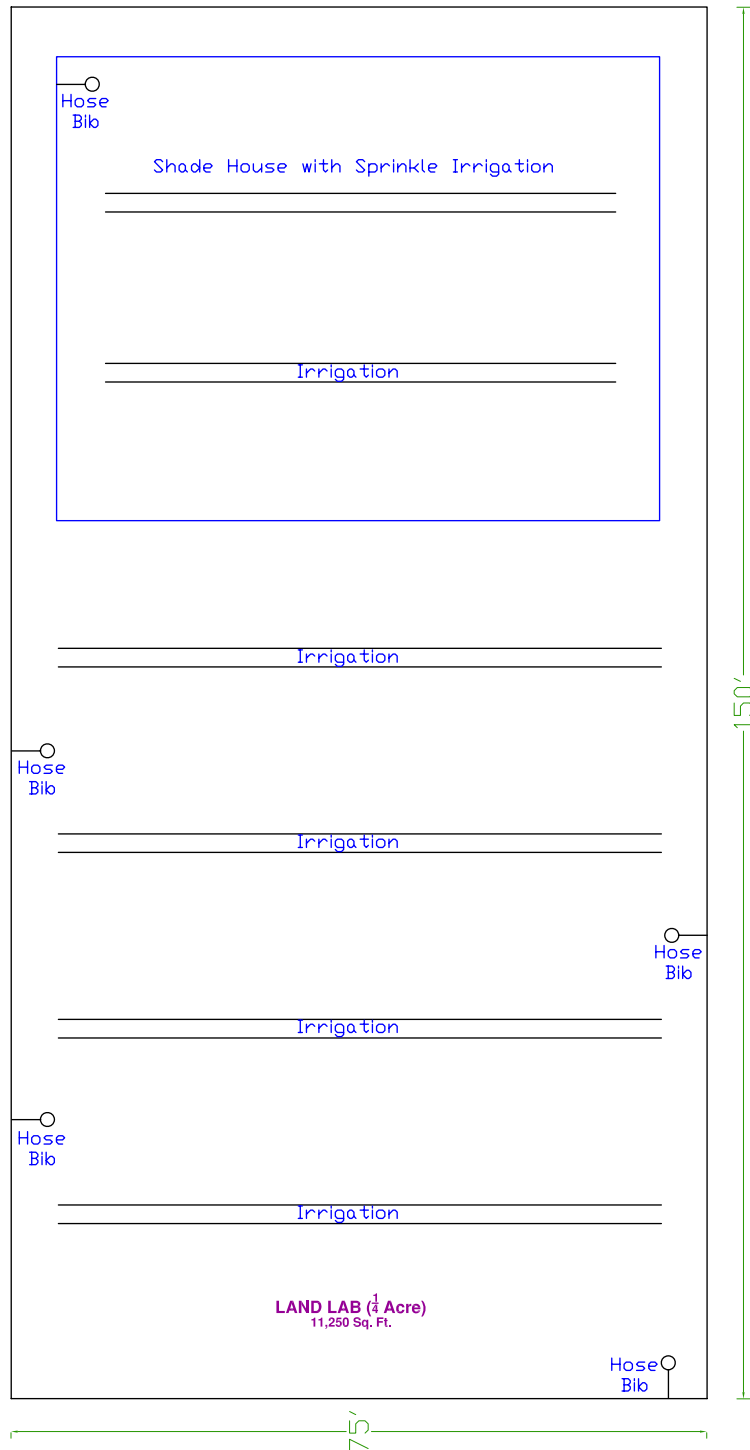

Please contact Kristin B. Pierce at x60180 for an AutoCAD drawing.